

Lamellenbefestigung M=12 (Vertikallamellen)

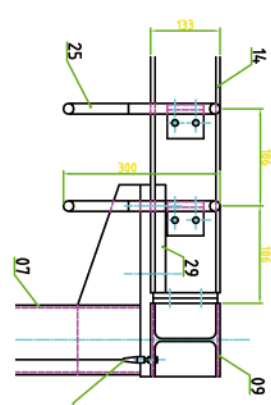

LEGEND:  
 Finish Galvanized steel  
 Deburr and slurr every side  
 Sun protection louvre boards Alu, galvanized  
 Once de louvre boards are fixed, the Holes in the HEK-support and in the angle are to be tested.  
 Pos. 27,28: NIRO Stainless steel wire rope diameter: 2,5-3mm and NIRO screws and socket  
 All diagonals are provided with M12 turnbuckles

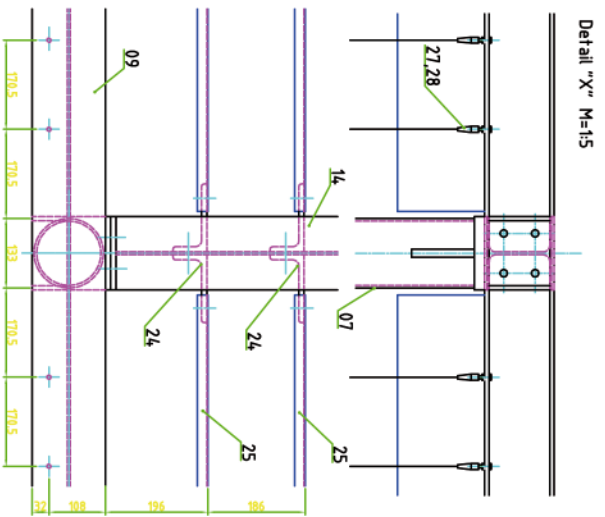
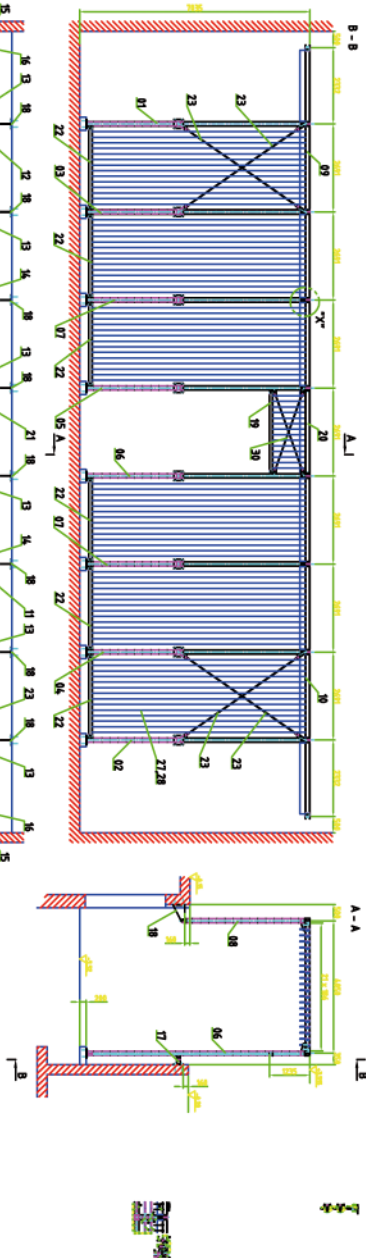
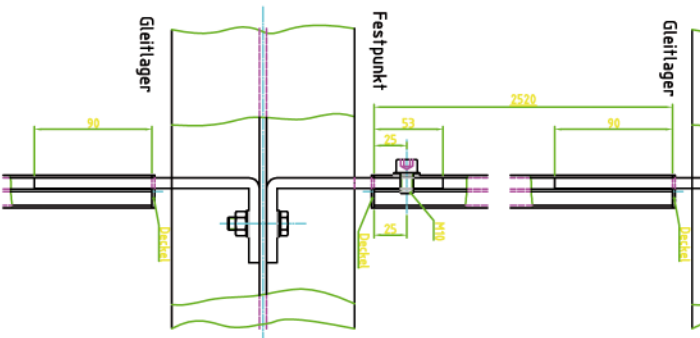
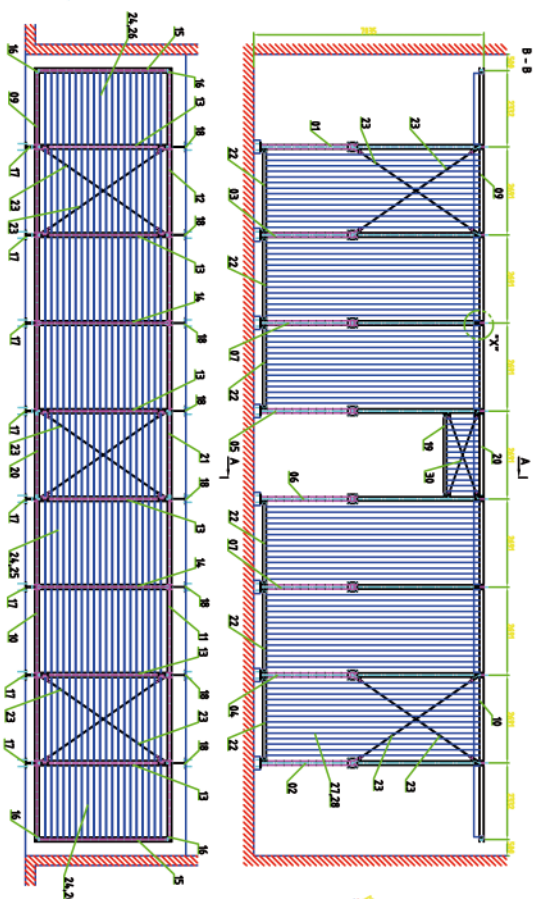
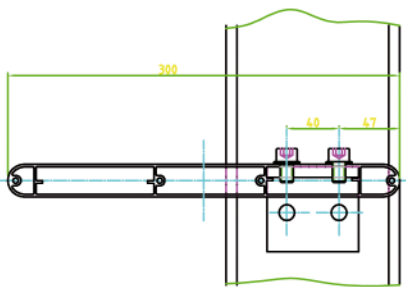

Änderung		Name	Date	Index
Contract Nr		00-033		
Execution contract		01		
Plan Nr.		00-033-01		
Surfaces		4400		
Pieces		2		
Date		23.04.07		
Date Name		Haller		
CLIENT		Neubacher GmbH.		
ARCHITECT		Architekt Wilhelm Holzbauer		
BUILDING PROJECT		LNK Wagner Jauregg Linz Pergola Klein		
COMPONENT		1:50		
Copyright and world distribution of this drawing stay exclusive to the company ALU-Systeme Martin Haller				
		Gumpertsgasse 1 4040 Linz Austria Phone: +43 (0)7320 333 44 Fax: +43 (0)7320 333 44 Email: office@haller.at www.haller.at		
UT003	Index	Plan Nr.	00-033-01	
S	A			